

EchoMaster backup alarms are designed to improve safety during backing up by providing loud tones in the vicinity of the vehicle.

Please ensure you read and understand all aspects of this manual before fitting or using your EchoMaster backup alarm. Choose a suitable mounting place dependent on the application. Ensure that there are no wiring harnesses or hoses/pipes located behind the panel before drilling.

email - support@aampglobal.com
phone - 866-931-8021

15500 Lightwave Drive, Suite 202
Clearwater, Florida 33760

EchoMaster is a Power Brand of **AAMP Global**
EchoMaster.com



BUA-97C

EchoMaster backup alarms are designed to improve safety during backing up by providing loud tones in the vicinity of the vehicle.

Please ensure you read and understand all aspects of this manual before fitting or using your EchoMaster backup alarm. Choose a suitable mounting place dependent on the application. Ensure that there are no wiring harnesses or hoses/pipes located behind the panel before drilling.

email - support@aampglobal.com
phone - 866-931-8021

15500 Lightwave Drive, Suite 202
Clearwater, Florida 33760

EchoMaster is a Power Brand of **AAMP Global**
EchoMaster.com



BUA-97C

Box Contents:

- ▶ Back Up Alarm
- ▶ Screws
- ▶ Manual

Wiring Diagram

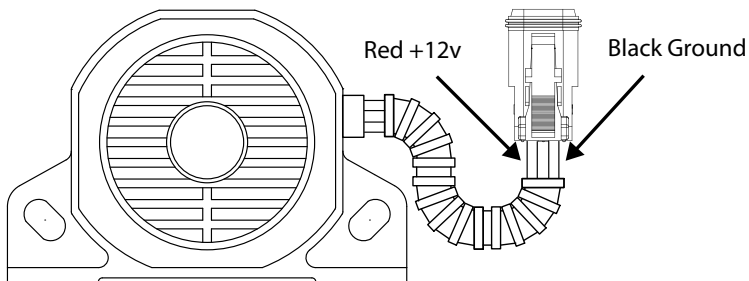

Dimensions:

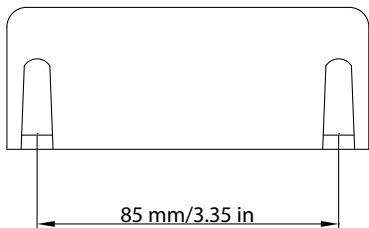
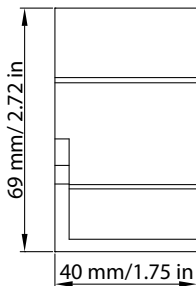
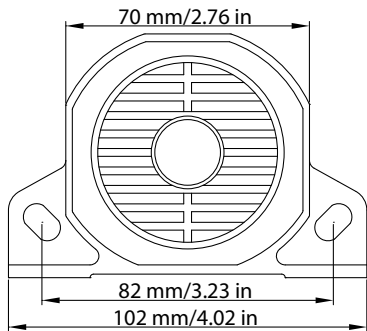

| | |
|-----------------|--------------|
| Part Number: | BUA-97C |
| Power: | 15W |
| Voltage: | DC12-24V |
| Current: | 300mA |
| dB/M: | 97dB |
| Material: | Nylon |
| Color: | Black |
| Frequency: | 3375Hz |
| Cycle: | 8±0 5/minute |
| Operating Temp: | -40 - +85 |
| Waterproof: | IP67 |

Box Contents:

- ▶ Back Up Alarm
- ▶ Screws
- ▶ Manual

Wiring Diagram

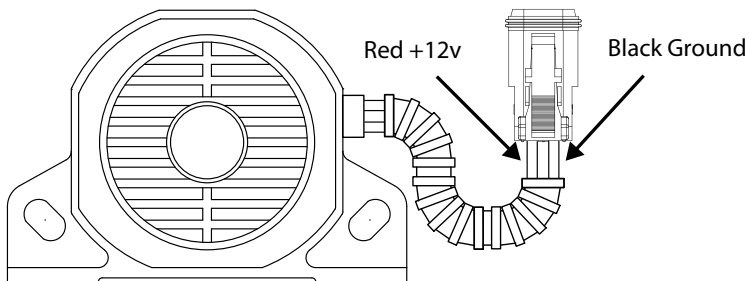

Dimensions:

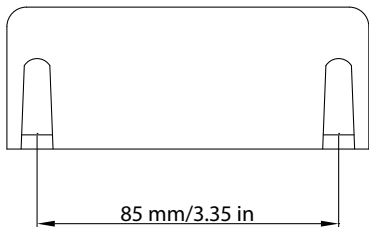
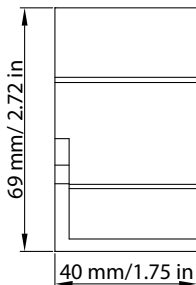
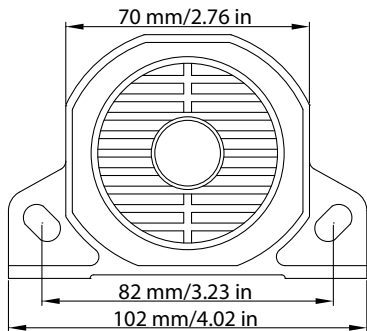

| | |
|-----------------|--------------|
| Part Number: | BUA-97C |
| Power: | 15W |
| Voltage: | DC12-24V |
| Current: | 300mA |
| dB/M: | 97dB |
| Material: | Nylon |
| Color: | Black |
| Frequency: | 3375Hz |
| Cycle: | 8±0 5/minute |
| Operating Temp: | -40 - +85 |
| Waterproof: | IP67 |