



TDH-LVDS

LVDS Camera Relocation Kit

INSTALLATION MANUAL

Stinger[®]



Thank you for purchasing the
TDH-LVDS



TABLE OF CONTENTS:

Page 3 - Kit Contents

Page 4 - Application Table

Page 5 - Installation Notes

Page 6 - 2019-2022 Silverado & 2020-2023 Silverado HD Assembly

Page 7 - 2023-2024 Colorado, 2022.5-2024 Silverado, & 2024 Silverado HD Assembly

Page 8 - 2017-2022 Super Duty Assembly

Page 9 - 2023-2024 Super Duty & 2021-2024 F-150 Assembly

Page 10 - 2019-2024 RAM 1500 & 2019-2024 RAM 2500/3500 HD Assembly

Page 11 - EchoMaster AHD Camera Assembly

Page 12 - Applying +/- 5 Degree Angle to Camera Housing

Page 13 - Applying +/- 10 Degree Angle to Camera Housing

Page 14 - Applying +/- 15 Degree Angle to Camera Housing

Page 15 - Applying +/- 20 Degree Angle to Camera Housing

WHAT'S INCLUDED:

- Housing
- Camera Mounting Inserts
- 15' LVDS Extension Harness
- Male to Male FAKRA Adapter
- Angled Mounting Shims
- Assembly Hardware





KIT CONTENTS:

Item	Description	Quantity
1	SCREW COVER	2
2	#8 X 2.0" SELF-DRILLING PHP SCREW	2
3	#8 X 1.5" SELF-DRILLING PHP SCREW	2
4	#8 X 1.25" SELF-DRILLING PHP SCREW	2
5	MAIN HOUSING	1
6	CAMERA INSERT PLATE 1A	1
7	CAMERA INSERT 1A	1
8	#6 X 5/16" TRUSS HEAD SCREW	2
9	CAMERA INSERT PLATE 2A	1
10	CAMERA INSERT 2A	1
11	M2 X 6MM PHP SCREW	2
12	#8 X 0.5" TAPPING PHP SCREW	2
13	CAMERA INSERT 3	1
14	CAMERA INSERT 4	1
15	CAMERA INSERT 5	1
16	CAMERA INSERT 6	1
17	BACK COVER	1
18	#6 X 7/16" TAPPING PHP SCREW	4
19	5 DEG. SPACER	2
20	10 DEG. SPACER	1
21	DOUBLE-SIDED TAPE	4
22	#6 X 1.0" FLAT HEAD SCREW	4
23	#6 X 1.5" FLAT HEAD SCREW	4
24	CLOSED-CELL EPDM FOAM	1
25	15' LVDS EXTENSION HARNESS	1
26	MALE TO MALE FAKRA ADAPTER	1
27	#6 X 1.75" FLAT HEAD SCREW	2

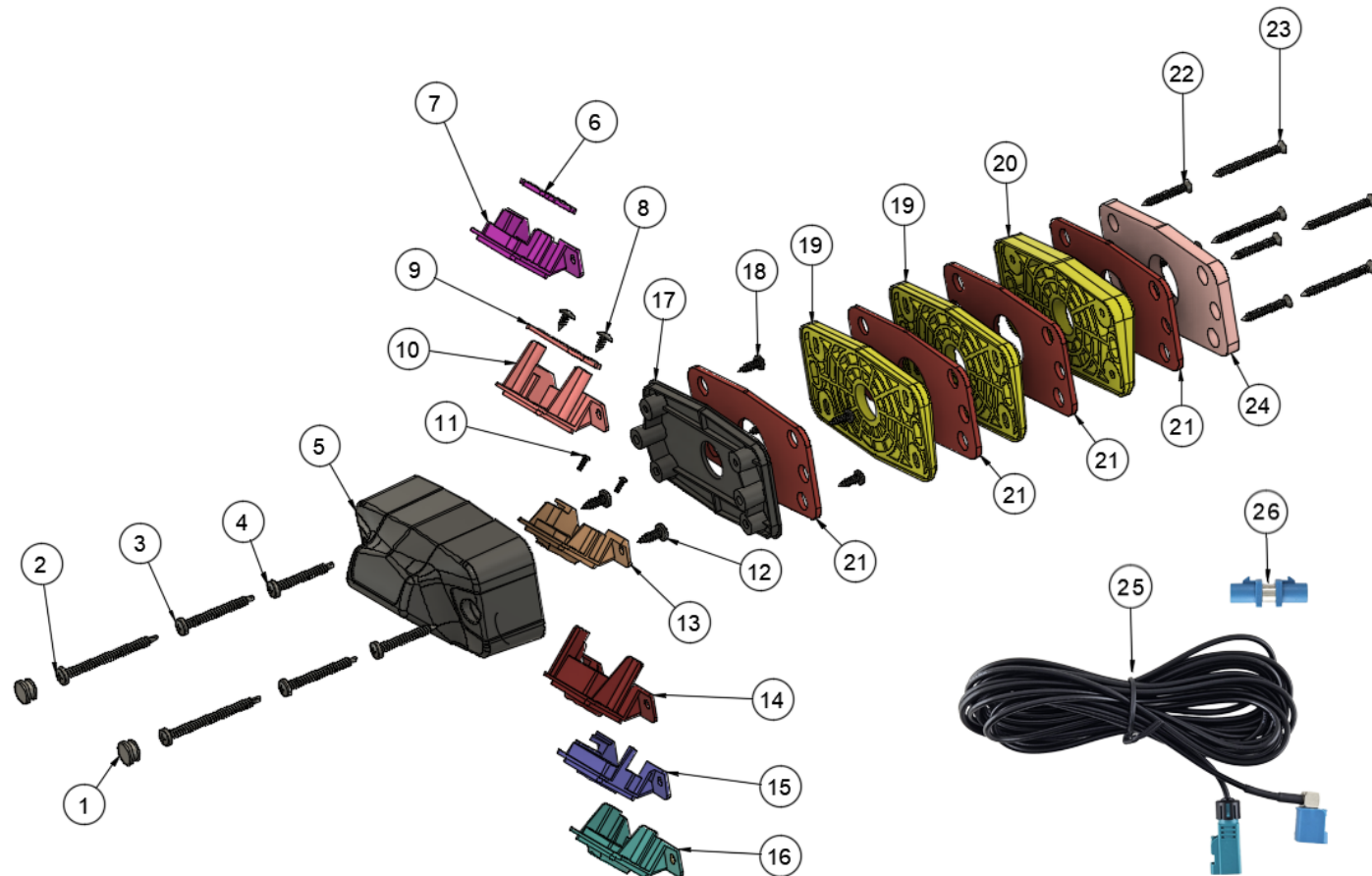



APPLICATION TABLE

Make	Model	Year	Notes	Insert
Chevrolet	Colorado	2023-2024	With or Without OEM 360	1A
Chevrolet	Silverado	2019-2022	With or Without OEM 360	6
Chevrolet	Silverado	2022.5-2024	With or Without OEM 360	1A
Chevrolet	Silverado HD	2020-2023	With 8" or OEM 360 (IOS/IOT)	6
Chevrolet	Silverado HD	2024	All Trims (IOR/IOK)	1A
Ford	Super Duty	2017-2022	With OEM 360	5
Ford	Super Duty	2023-2024	With or Without OEM 360	4
Ford	F-150	2021-2024	With or Without OEM 360	4
RAM	1500	2019-2024	(DT) Without OEM 360	3
RAM	2500/3500 HD	2019-2024	Without OEM 360	3
EchoMaster	AHD Camera	All	Full View Camera System	2A

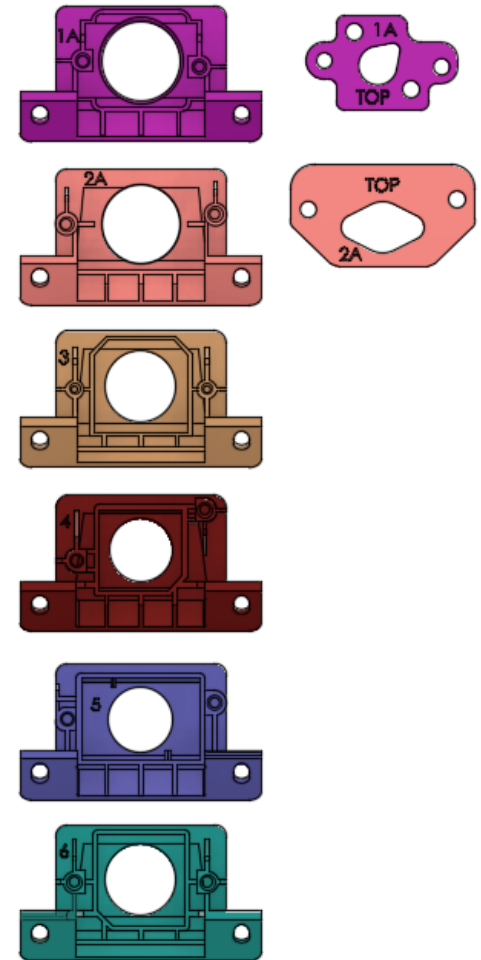



INSTALLATION NOTES

RAM Truck Installations:

These installations require use of the supplied Male to Male FAKRA Adapter between the 15' LVDS Extension Harness and the vehicle connector below the truck.

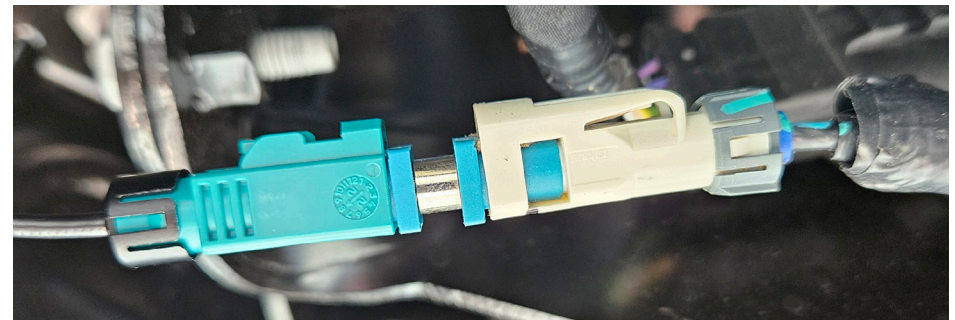

Extension Harness Connection to OEM Camera Connection:

Because the extension harness right-angle connector is equipped with a seal, the connection between the connector and the OEM camera may require firm pressure to fully seat.

The connection should make a “click” sound when the connector is fully seated and locked.

Fully Seated Connection



Connector tab/lock
is locked and flat

Not Fully Seated Connection



Connector tab/lock
is not locked, and is
not flat



2019-2022 Silverado & 2020-2023 Silverado HD Assembly

Item	Description	Quantity
1	SCREW COVER	2
4	#8 X 1.25" SELF-DRILLING PHP SCREW	2
5	MAIN HOUSING	1
8	#6 X 5/16" TRUSS HEAD SCREW	2
12	#8 X 0.5" TAPPING PHP SCREW	2
16	CAMERA INSERT 6	1
17	BACK COVER	1
18	#6 X 7/16" TAPPING PHP SCREW	4
21	DOUBLE-SIDED TAPE	1
24	CLOSED-CELL EPDM FOAM	1

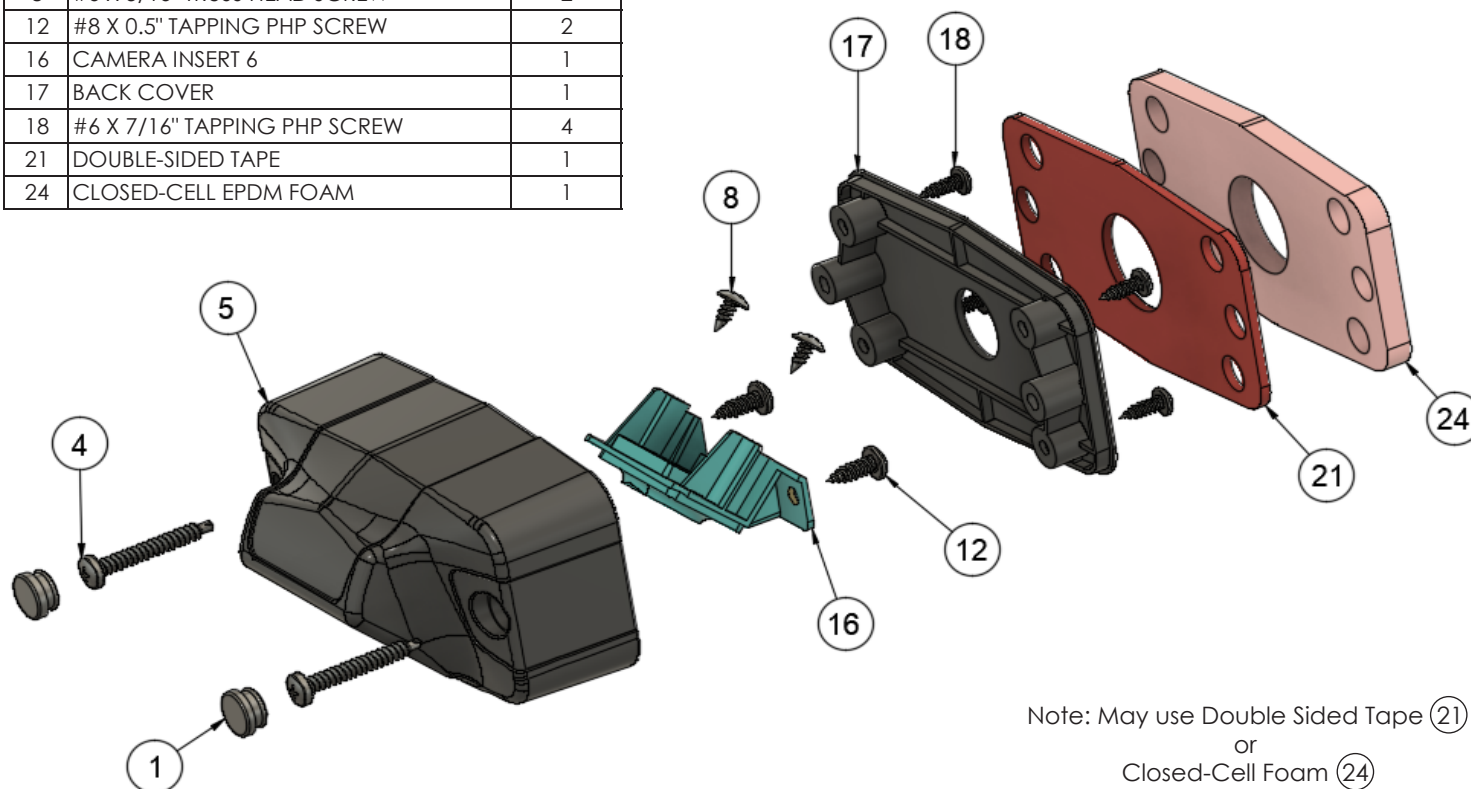

Camera Orientation



Note: May use Double Sided Tape (21)
or
Closed-Cell Foam (24)
as a gasket for mounting to vehicle.



2023-2024 Colorado, 2022.5-2024 Silverado, & 2024 Silverado HD Assembly

Item	Description	Quantity
1	SCREW COVER	2
4	#8 X 1.25" SELF-DRILLING PHP SCREW	2
5	MAIN HOUSING	1
6	CAMERA INSERT PLATE 1A	1
7	CAMERA INSERT 1A	1
8	#6 X 5/16" TRUSS HEAD SCREW	2
17	BACK COVER	1
18	#6 X 7/16" TAPPING PHP SCREW	4
21	DOUBLE-SIDED TAPE	1
24	CLOSED-CELL EPDM FOAM	1

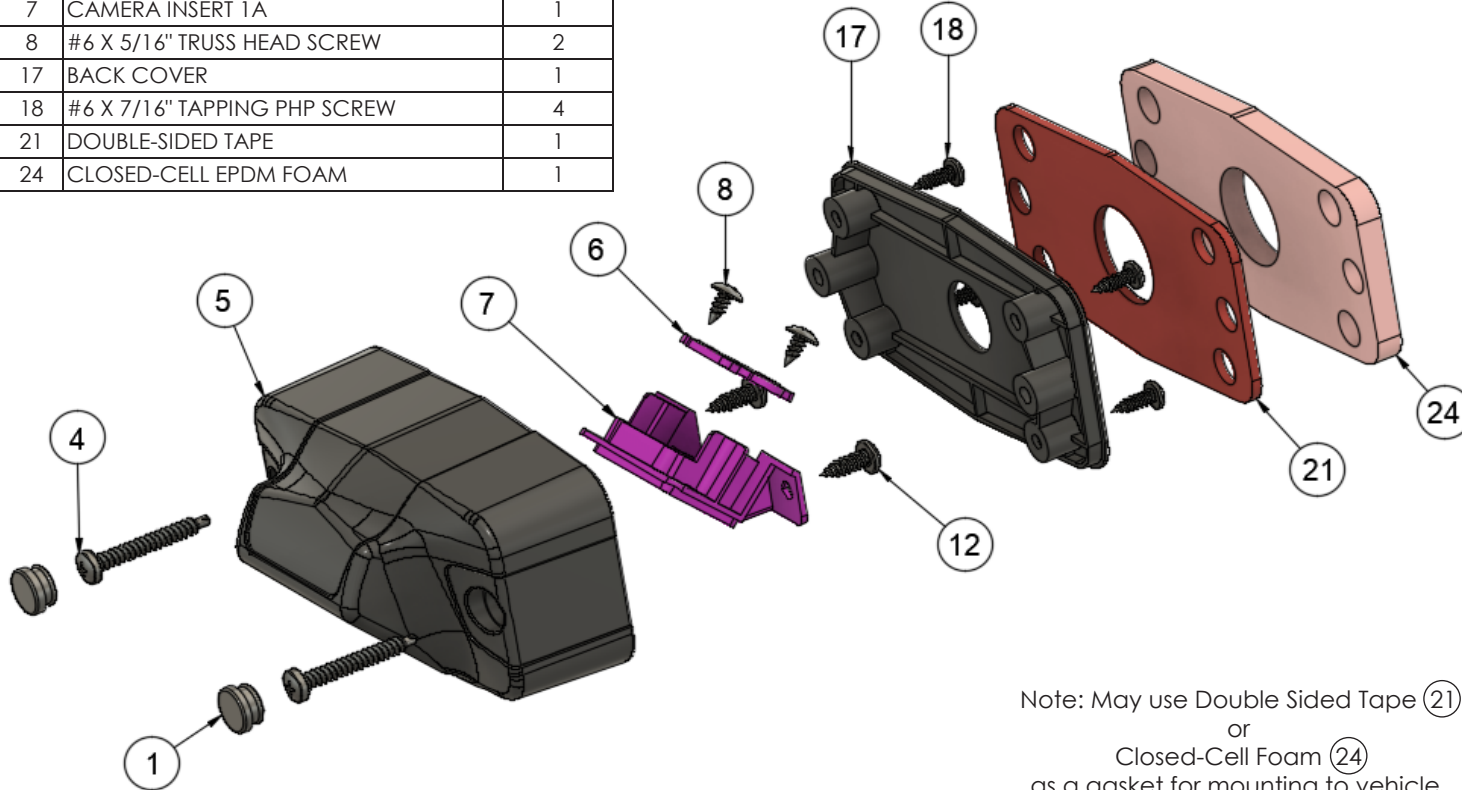

Camera Orientation

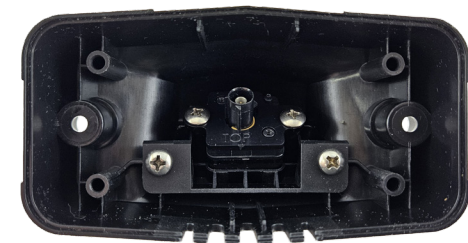

Note: May use Double Sided Tape (21)
or
Closed-Cell Foam (24)
as a gasket for mounting to vehicle.



2017-2022 Super Duty Assembly

Item	Description	Quantity
1	SCREW COVER	2
4	#8 X 1.25" SELF-DRILLING PHP SCREW	2
5	MAIN HOUSING	1
8	#6 X 5/16" TRUSS HEAD SCREW	2
12	#8 X 0.5" TAPPING PHP SCREW	2
15	CAMERA INSERT 5	1
17	BACK COVER	1
18	#6 X 7/16" TAPPING PHP SCREW	4
21	DOUBLE-SIDED TAPE	1
24	CLOSED-CELL EPDM FOAM	1

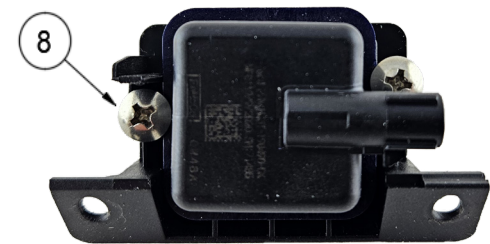
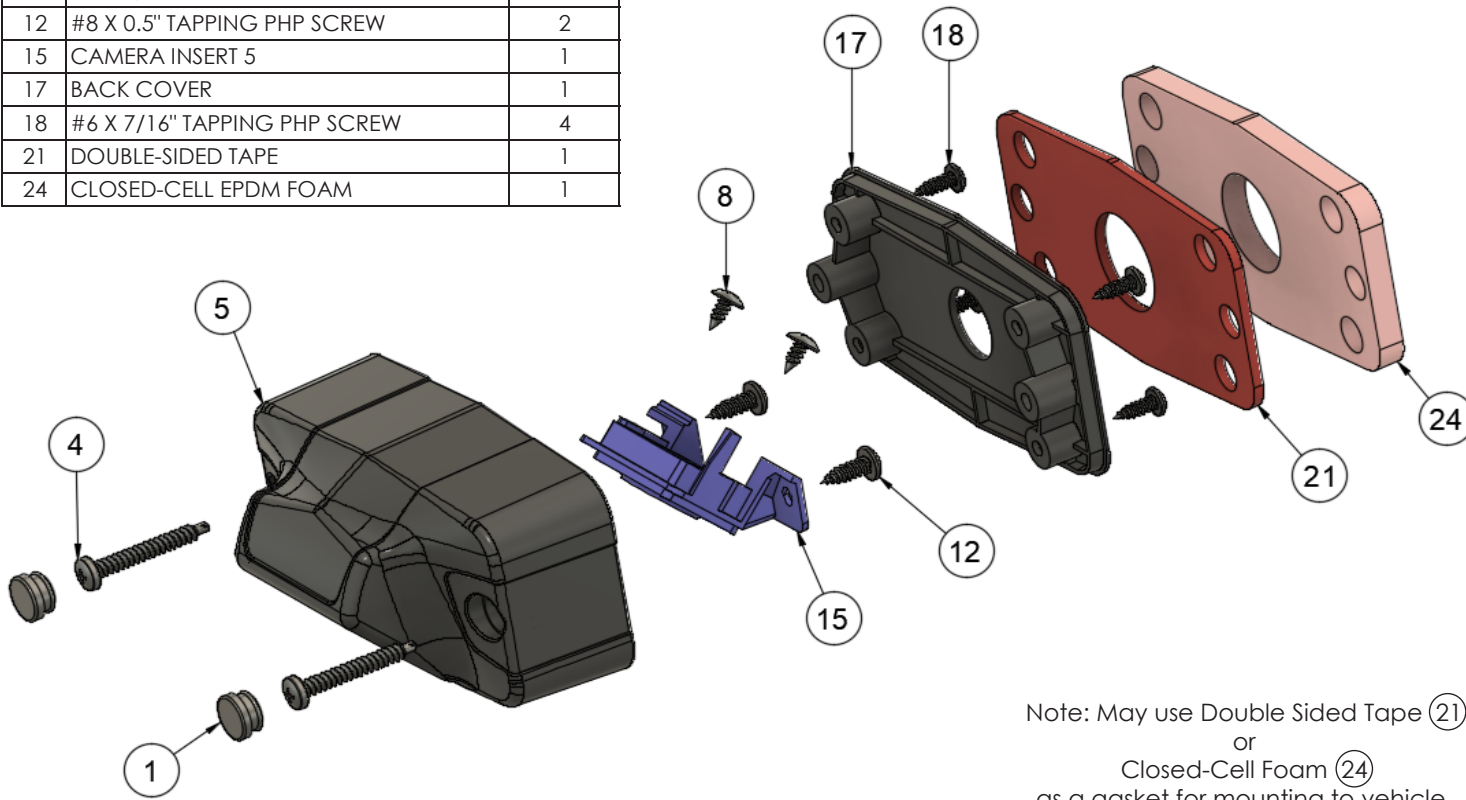

Camera Orientation

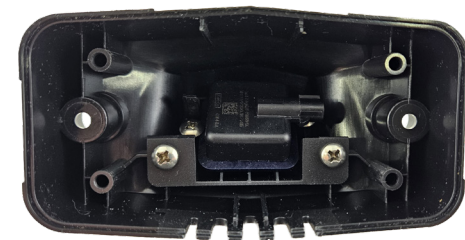

Note: May use Double Sided Tape (21)
or
Closed-Cell Foam (24)
as a gasket for mounting to vehicle.



2023-2024 Super Duty & 2021-2024 F-150 Assembly

Item	Description	Quantity
1	SCREW COVER	2
4	#8 X 1.25" SELF-DRILLING PHP SCREW	2
5	MAIN HOUSING	1
8	#6 X 5/16" TRUSS HEAD SCREW	2
12	#8 X 0.5" TAPPING PHP SCREW	2
14	CAMERA INSERT 4	1
17	BACK COVER	1
18	#6 X 7/16" TAPPING PHP SCREW	4
21	DOUBLE-SIDED TAPE	1
24	CLOSED-CELL EPDM FOAM	1

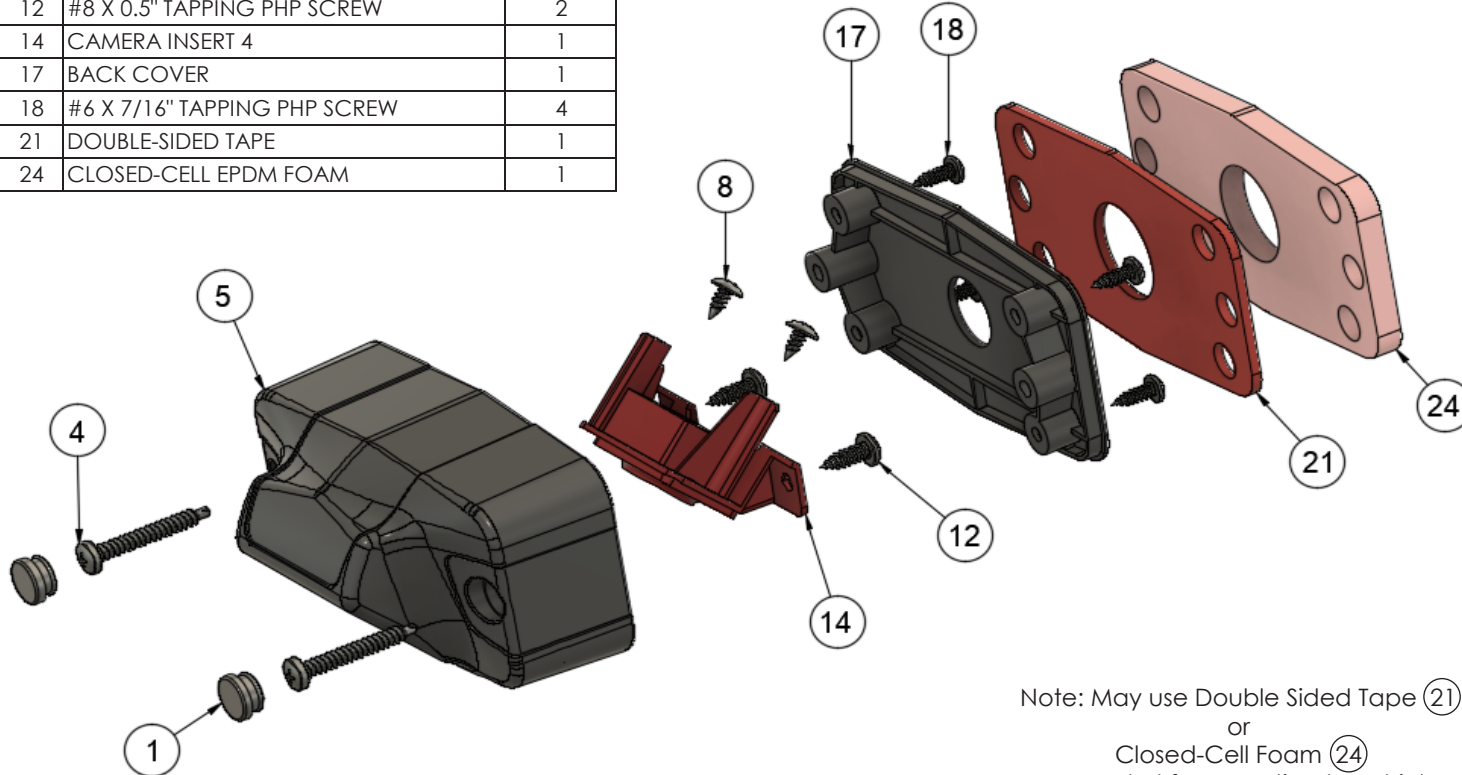

Camera Orientation

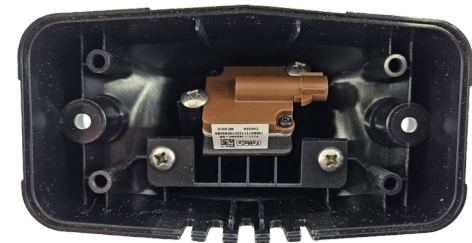

Note: May use Double Sided Tape (21)
or
Closed-Cell Foam (24)
as a gasket for mounting to vehicle.



2019-2024 RAM 1500 & 2019-2024 RAM 2500/3500 HD Assembly

Item	Description	Quantity
1	SCREW COVER	2
4	#8 X 1.25" SELF-DRILLING PHP SCREW	2
5	MAIN HOUSING	1
11	M2 X 6MM PHP SCREW	2
12	#8 X 0.5" TAPPING PHP SCREW	2
13	CAMERA INSERT 3	1
17	BACK COVER	1
18	#6 X 7/16" TAPPING PHP SCREW	4
21	DOUBLE-SIDED TAPE	1
24	CLOSED-CELL EPDM FOAM	1

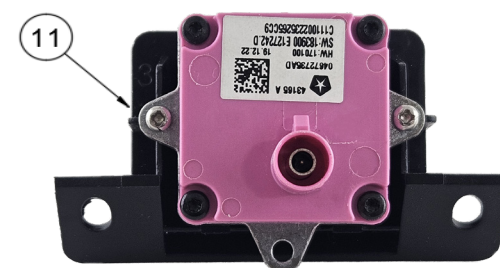
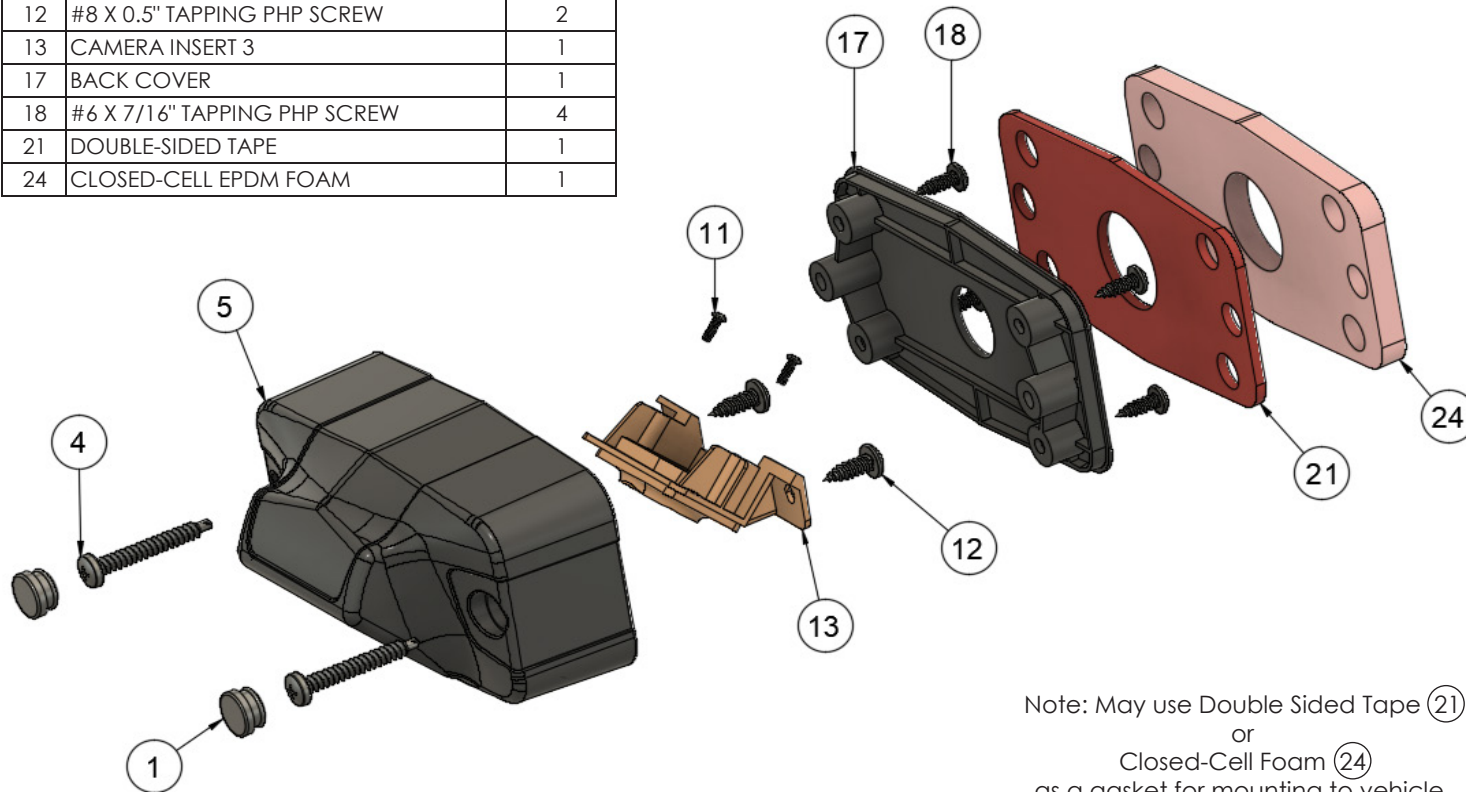

Camera Orientation

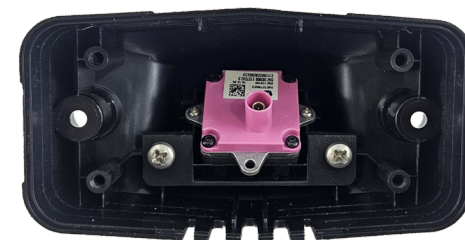

Note: May use Double Sided Tape (21)
or
Closed-Cell Foam (24)
as a gasket for mounting to vehicle.



EchoMaster AHD Camera Assembly

Item	Description	Quantity
1	SCREW COVER	2
4	#8 X 1.25" SELF-DRILLING PHP SCREW	2
5	MAIN HOUSING	1
8	#6 X 5/16" TRUSS HEAD SCREW	2
9	CAMERA INSERT PLATE 2A	1
10	CAMERA INSERT 2A	1
12	#8 X 0.5" TAPPING PHP SCREW	2
17	BACK COVER	1
18	#6 X 7/16" TAPPING PHP SCREW	4
21	DOUBLE-SIDED TAPE	1
24	CLOSED-CELL EPDM FOAM	1

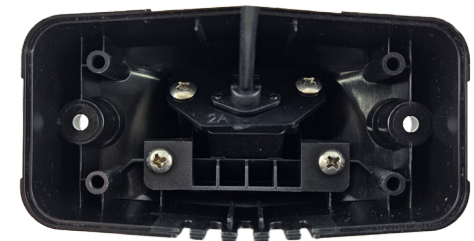
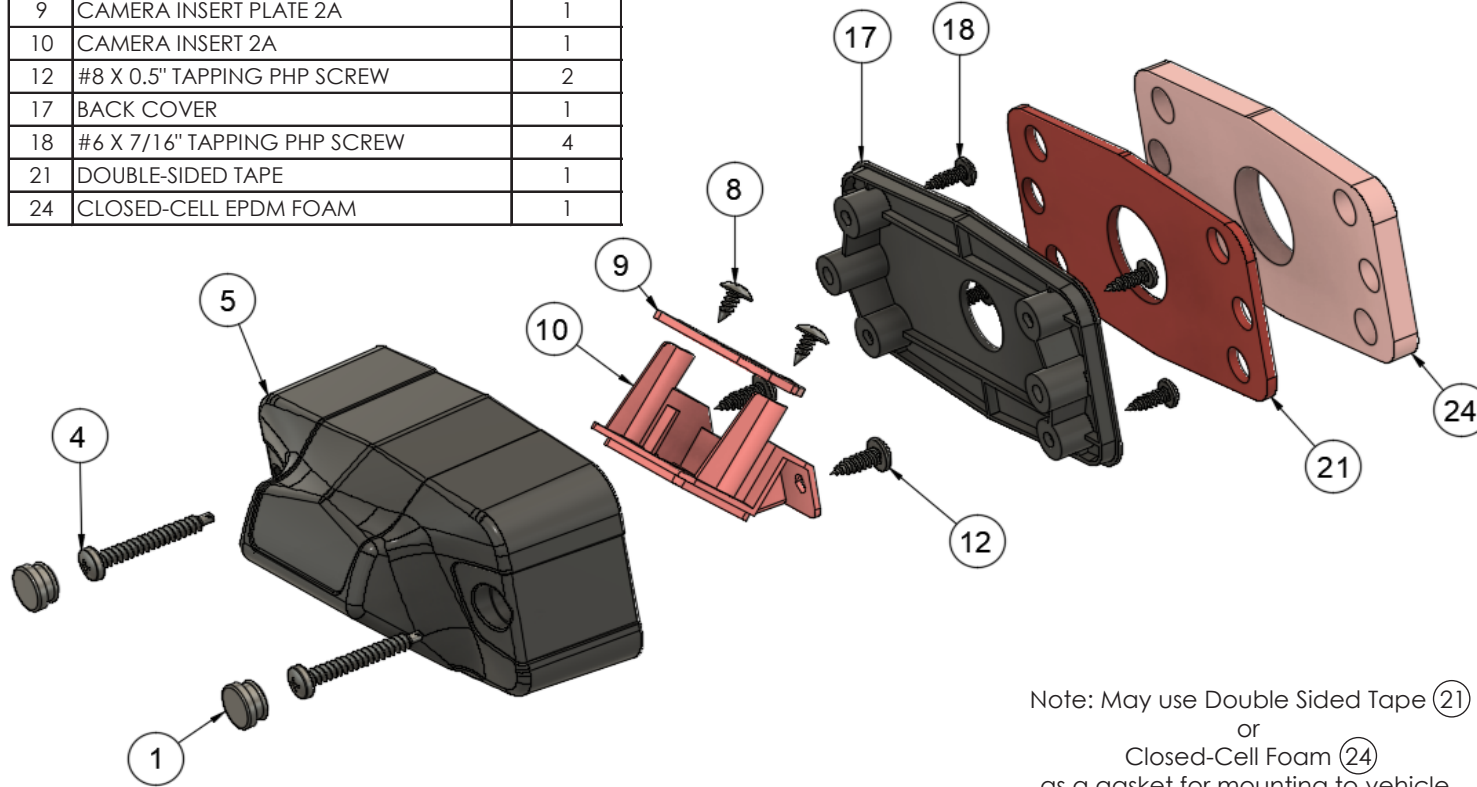

Note: May use Double Sided Tape (21)
or
Closed-Cell Foam (24)
as a gasket for mounting to vehicle.



5 Degree Shim Assembly

Item	Description	Quantity
1	SCREW COVER	2
3	#8 X 1.5" SELF-DRILLING PHP SCREW	2
5	MAIN HOUSING	1
17	BACK COVER	1
19	5 DEG. SPACER	1
21	DOUBLE-SIDED TAPE	1
22	#6 X 1.0" FLAT HEAD SCREW	4
24	CLOSED-CELL EPDM FOAM	1

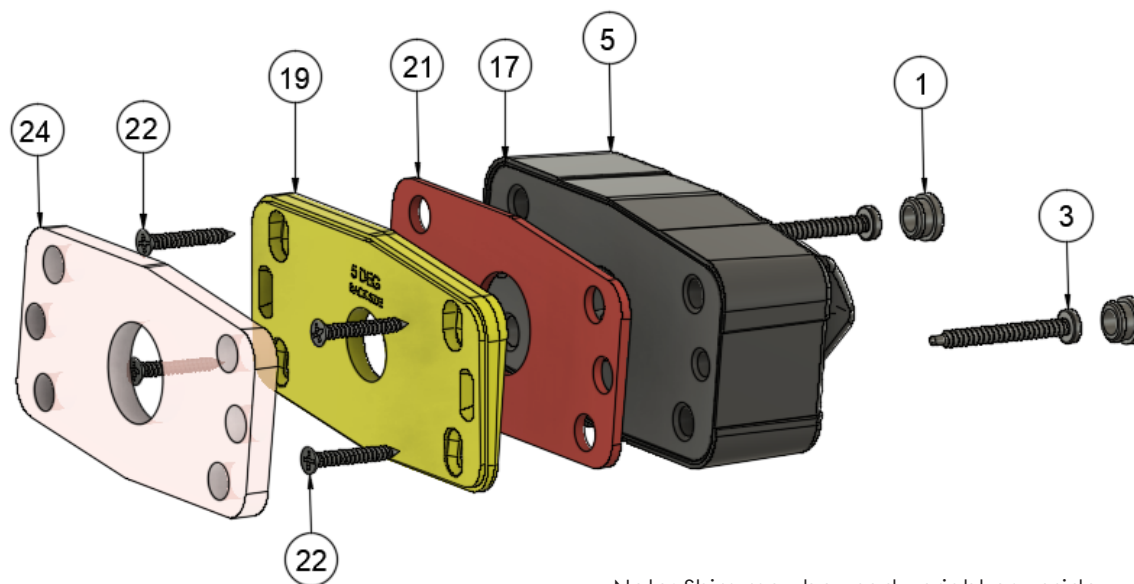

Note: Shim may be used upright or upside down to achieve a positive or negative angle adjustment.



10 Degree Shim Assembly

Item	Description	Quantity
1	SCREW COVER	2
3	#8 X 1.5" SELF-DRILLING PHP SCREW	2
5	MAIN HOUSING	1
17	BACK COVER	1
20	10 DEG. SPACER	1
21	DOUBLE-SIDED TAPE	1
22	#6 X 1.0" FLAT HEAD SCREW	4
24	CLOSED-CELL EPDM FOAM	1

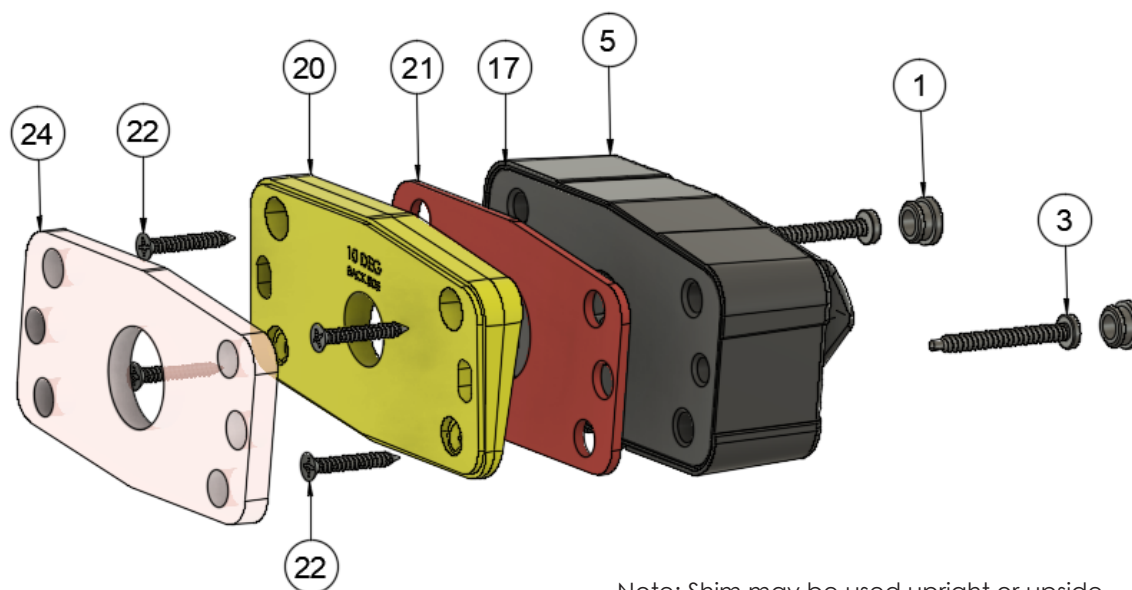

Note: Shim may be used upright or upside down to achieve a positive or negative angle adjustment.



15 Degree Shim Assembly

Item	Description	Quantity
1	SCREW COVER	2
2	#8 X 2.0" SELF-DRILLING PHP SCREW	2
5	MAIN HOUSING	1
17	BACK COVER	1
19	5 DEG. SPACER	1
20	10 DEG. SPACER	1
21	DOUBLE-SIDED TAPE	2
22	#6 X 1.0" FLAT HEAD SCREW	2
23	#6 X 1.5" FLAT HEAD SCREW	2
24	CLOSED-CELL EPDM FOAM	1

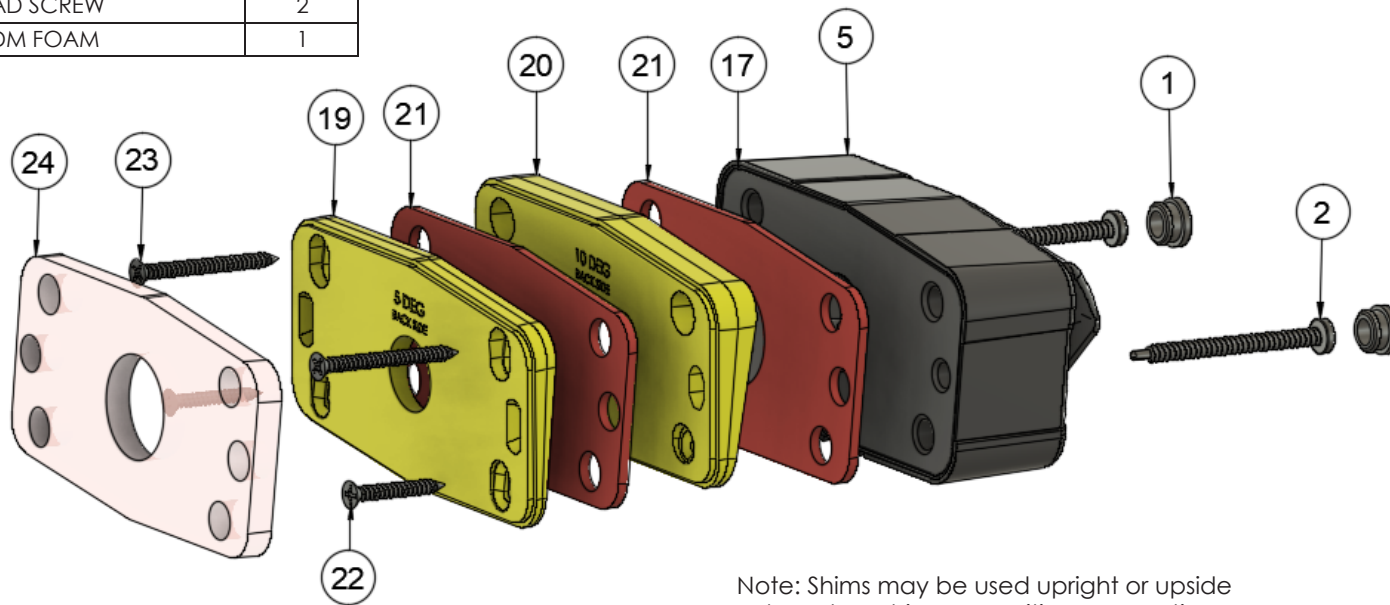

Note: Shims may be used upright or upside down to achieve a positive or negative angle adjustment.



20 Degree Shim Assembly

Item	Description	Quantity
1	SCREW COVER	2
2	#8 X 2.0" SELF-DRILLING PHP SCREW	2
5	MAIN HOUSING	1
17	BACK COVER	1
19	5 DEG. SPACER	2
20	10 DEG. SPACER	1
21	DOUBLE-SIDED TAPE	3
23	#6 X 1.5" FLAT HEAD SCREW	2
24	CLOSED-CELL EPDM FOAM	1
27	#6 X 1.75" FLAT HEAD SCREW	2

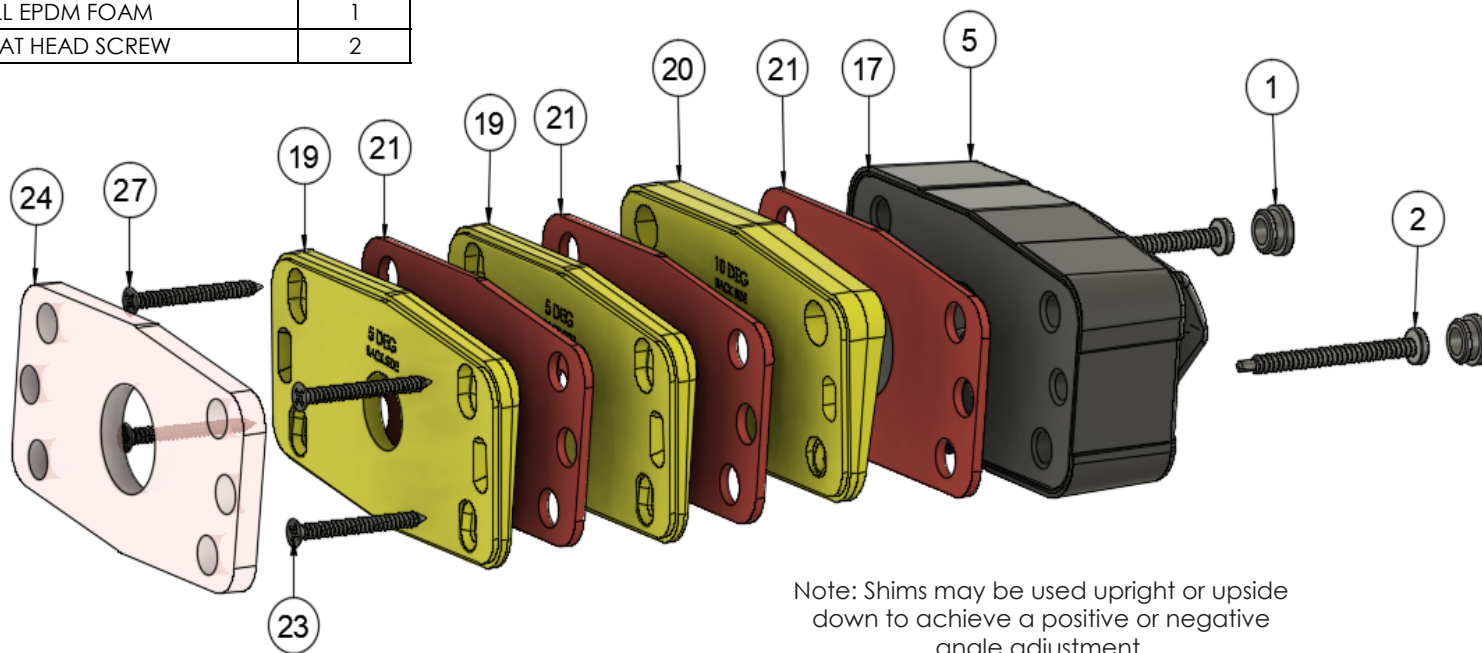

Note: Shims may be used upright or upside down to achieve a positive or negative angle adjustment.



Phone – 866-931-8021 (option 3)

E-Mail – techsupport@stingersolutions.com

StingerSolutions.com